



MADE IN BELGIUM

FETON INTERNATIONAL SPRL

# DATASHEET

## UNIVERSAL FILLER 400



Rue de la Croix du Maître, 8 - 7110 Strépy-Bracquegnies - Belgium  
Tel : +32-2-420 52 00 / contact@feton.com  
TVA BE 0674 542 750 / ING BE07-3630665252-66 / BIC : BBRUBEBB





## FETON International SPRL

 **Rue de la Croix du Maïeur, 8  
7110 Strépy-Bracquegnies.  
Belgium**

 **Tel : +32-2-420 52 00**  
 **contact@feton.com**

---

TVA BE 0674 542 750  
ING BE07-3630665252-66  
BIC : BBRUBEBB

## CONTENTS

|          |  |           |
|----------|--|-----------|
| <b>1</b> | <b>PRODUCT PRESENTATION</b>              | <b>5</b>  |
| <b>2</b> | <b>SAFETY INFORMATION AND DISCLAIMER</b> | <b>5</b>  |
| <b>3</b> | <b>TECHNICAL DATA</b>                    | <b>6</b>  |
| <b>4</b> | <b>HOW TO USE</b>                        | <b>8</b>  |
| <b>5</b> | <b>HOW TO CLEAN</b>                      | <b>10</b> |

## 1 PRODUCT PRESENTATION

The Universal Filler 400 is composed of a unique and robust frame and plates sets corresponding to different capsule sizes.

- One single frame for all capsule sizes.
- Only metallic plates and frame.
- Fill capsule sizes 4, 3, 2, 1, 0, 00 and 000.
- No adjustment necessary.
- 400 capsules at a time.
- Extra space to fill the capsules.
- Very robust design.
- Easy to clean.

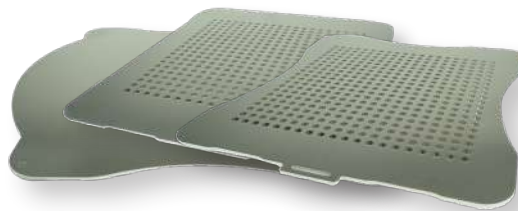

## 2 SAFETY INFORMATION AND DISCLAIMER

All material should be cleaned before every use. (refer to section 5)

Many parts are heavy and might cause injury if mishandled or in case of fall.

Always work on a stable and flat surface, at a height that is comfortable to work while standing. Have sufficient free space around the machine you are working with.

As the filling is manual, results may vary depending on the user. Other factors can influence the results such as but not limited to: type of powder, number of tamps, filling weight, capsule size, vibration type and intensity. It is the responsibility of the user to make sure the prescribed dose is respected. Feton International is not responsible for wrong dosing.

Illustrations, descriptions and specifications are not contractual and are subject to change without prior notice.

Feton International sprl declines all liability in the event of improper use of its products.

### 3 TECHNICAL DATA

#### 3.1 COMPONENTS LIST AND MATERIALS

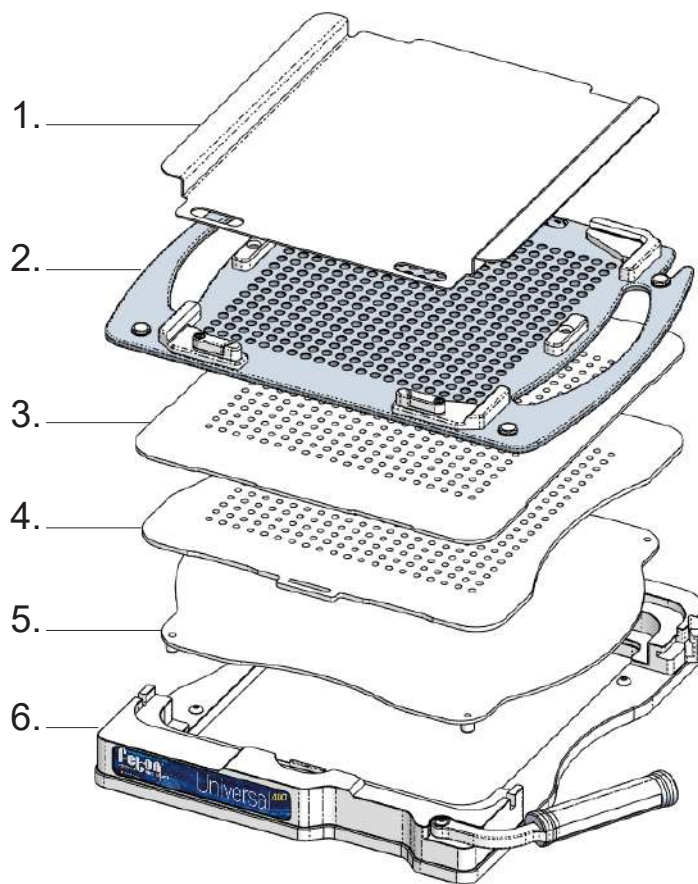

| Item N° | Quantity | Name          | Material            |
|---------|----------|---------------|---------------------|
| 1       | 1        | Lid           | 316 Stainless Steel |
| 2       | 1        | Top Plate     | Anodised Aluminium  |
| 3       | 1        | Filling Plate | 316 Stainless Steel |
| 4       | 1        | Bottom Plate  | 316 Stainless Steel |
| 5       | 1        | Spacer Plate  | 316 Stainless Steel |
| 6       | 1        | Frame         | 304 Stainless Steel |

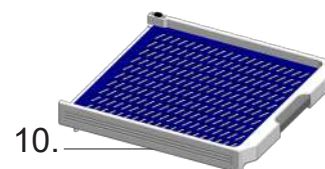
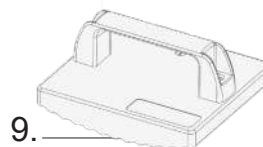
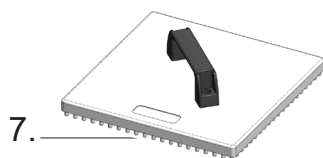

| Item N° | Quantity | Name                                | Material                                   |
|---------|----------|-------------------------------------|--|
| 7       | 1        | Tamper 400 pins (optional)          | POM White                                  |
| 8       | 1        | Powder Stop with reserve (optional) | 316 Stainless Steel and Anodised Aluminium |
| 9       | 1        | Serial Closer (optional)            | POM White                                  |
| 10      | 1        | Capsule Loader (optional)           | POM White                                  |

### 3.2 DIMENSIONS AND WEIGHT

**Weight  
(frame + plates set)**

From 19 kg (size 000) to 20,5 kg (size 4)

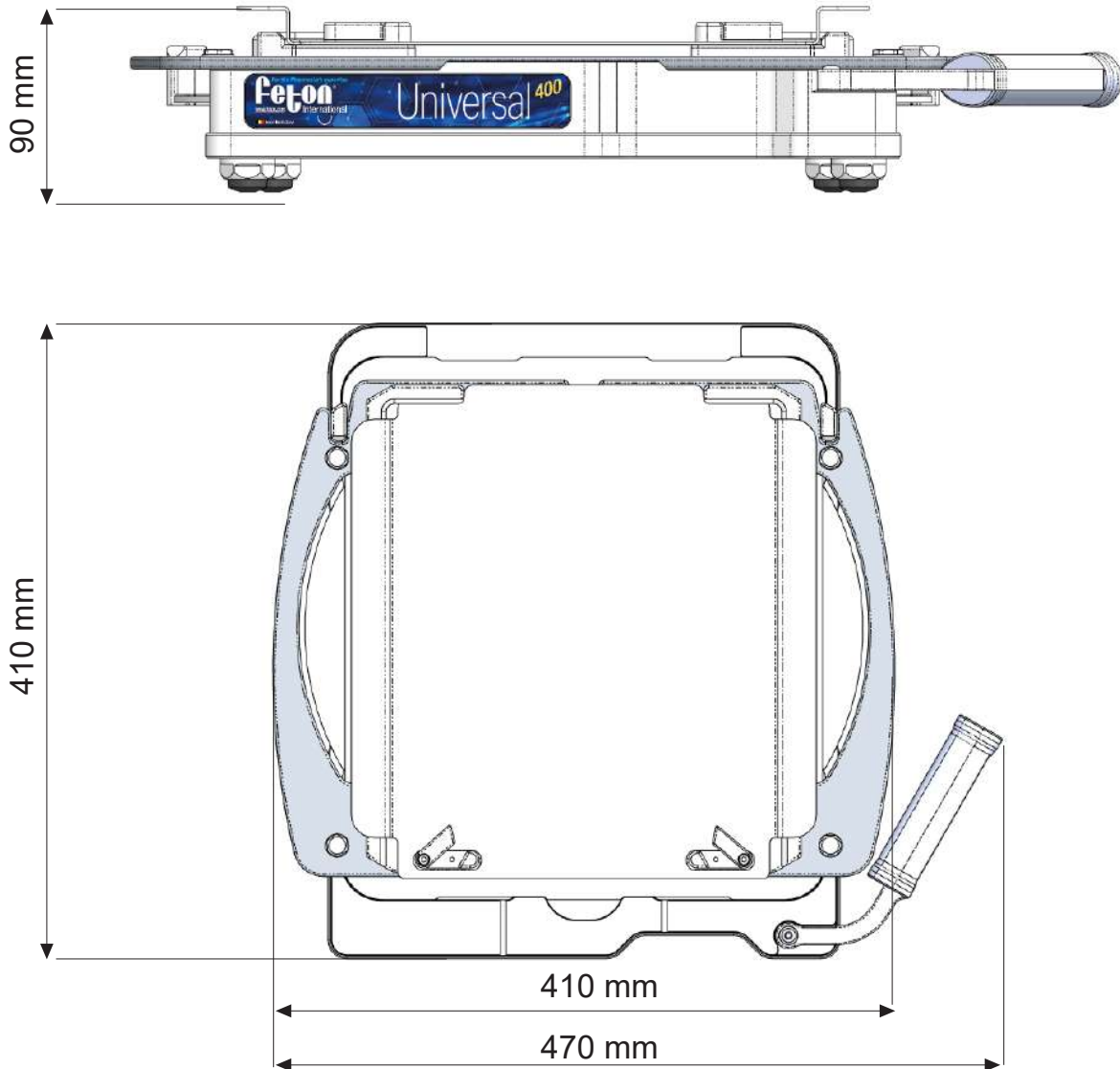

Each set of plates, used for one specific capsule size, is composed of:

- 1 Spacer plate;
- 1 Bottom plate;
- 1 Filing plate;
- 1 Top plate.



## 4 HOW TO USE

**NOTE :** Operate your capsule filler at least one time without filling the capsules (steps 3-4-5-8) at the start of every preparation. This will allow you to check that everything is working correctly.

*See table beside for visual instructions. (p.9-10)*

1. Prepare your material: choose the right set of plates for the capsule size you are using. Install the plates in this order: Spacer plate, Bottom Plate, Filling Plate, Top Plate.
2. If you have a capsule Loader, please refer to the Loader datasheet for instructions. If you do not have a capsule Loader, place the capsules into the Top Plate one by one or with our Feton Cards. 
3. Pull the Lever to lock the capsules' bodies.
4. Pull the Top Plate upwards, starting from the front side for easier separation.
5. Release the Lever. If needed, push on the capsules' bodies so that they are flush with the Filling Plate.
6. Fill the capsules with your preparation.
7. If needed, you can use a Tamper400 to push the powder into the capsules to be able to fill a higher volume.
8. Place the Top Plate with the locked lid. Pull up the Base Plate to push the capsules' bodies into the capsules' heads. The capsules are now **“pre-closed”**.
9. Take the Top Plate with the locked lid and turn it upside down on your table. If you have a Serial Closer, use it to close the capsules in one motion. If not, close the capsules by hand.
10. Open the lid and push the capsules out of the top plate. Use a container to collect the capsules.





1.

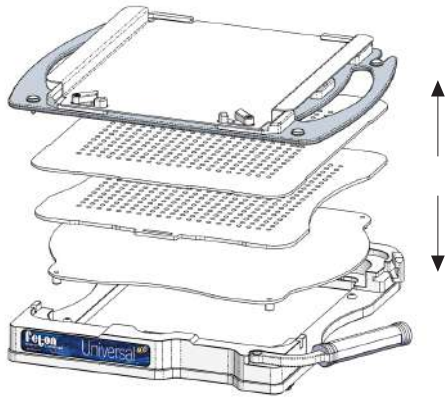

2.

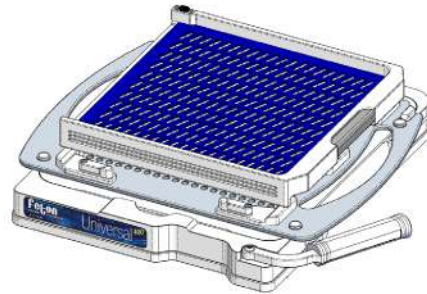

3.

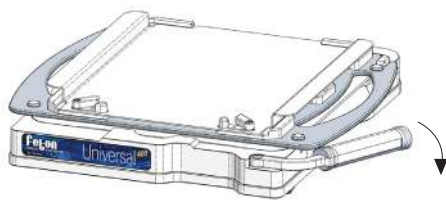

4.

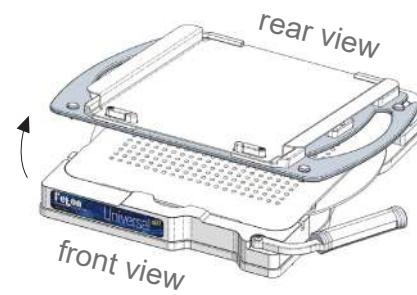

5.

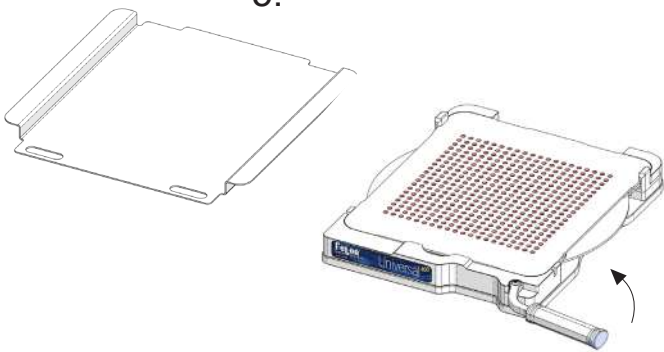

6.

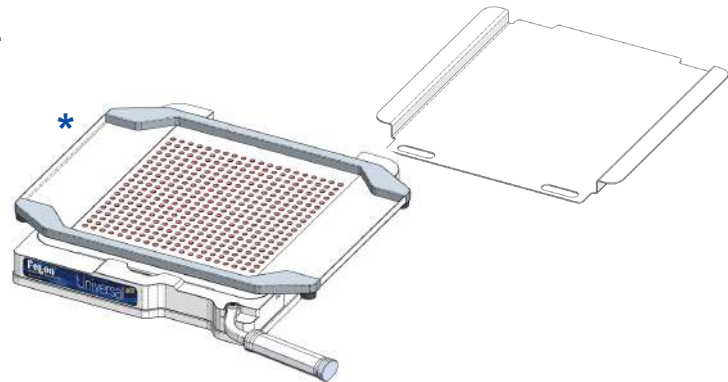

7.

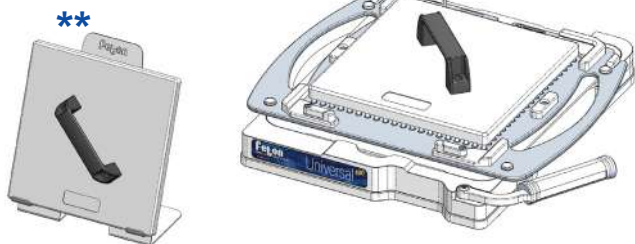

8.

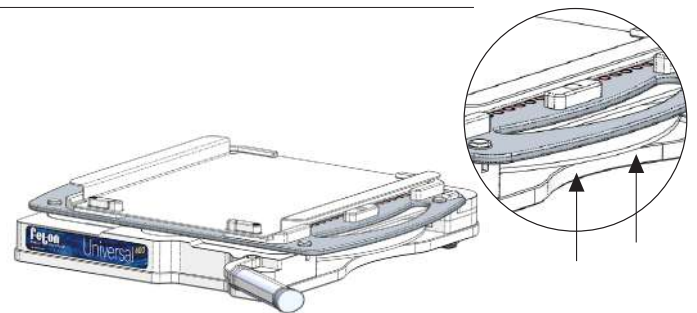

\* Optional accessory : Powder stop with reserve : REF : APR400UN  
 \*\* Optional accessory : Tamper : REF : TAS400CR-\*\*\* ((000/00 - 0/1/2 - 3/4) + BASE)  
 \*\*\* Optional accessory : Serial Closer : REF : SECL-0/1/2/3/4/5 or SECL-000/00

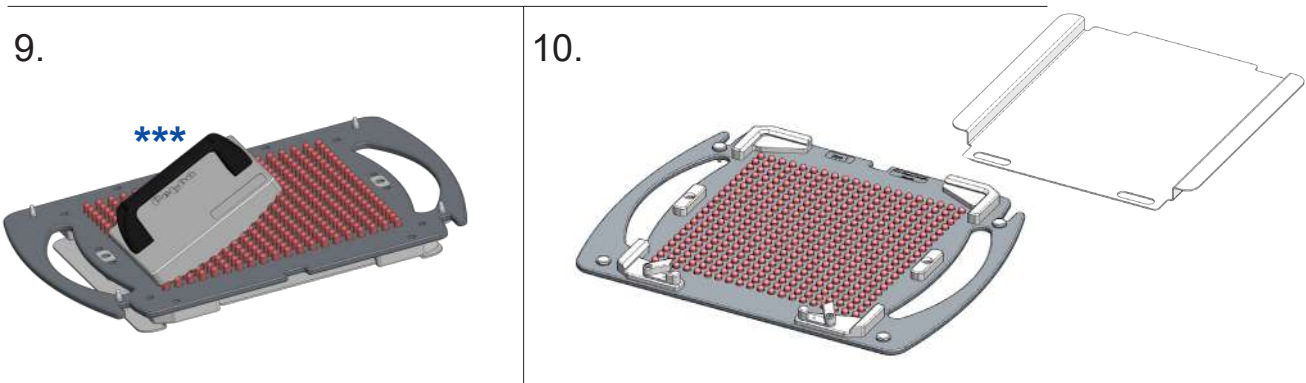

\* Optional accessory : Powder stop with reserve : REF : APR400UN

\*\* Optional accessory : Tamper : REF : TAS400CR-\*\*\* ((000/00 - 0/1/2 - 3/4) + BASE)

\*\*\* Optional accessory : Serial Closer : REF : SECL-0/1/2/3/4/5 or SECL-000/00

## 5 HOW TO CLEAN

**It is important** to clean the parts in contact with the capsules or the powder thoroughly between each use to avoid contamination. Cleaning can be done by hand, in a dishwasher or in an autoclave.

If done by hand, use warm water and soap.

If done in a dishwasher :

- All metal parts : Use a maximum temperature of 110°C/230°F.
- All plastic parts : Use a maximum temperature of 40°C/104°F.

If you have difficulty cleaning the inside of the holes of the plates, use the small Feton-cleaning brush :



REF. BRU

## For information - Note for Anodised Aluminium parts :

If done in a dishwasher or in an autoclave, do not use alkaline or acid cleaning product that are not suitable for treated aluminium (nickel or anodized), as they oxidize the surface treatment of the plates which could deteriorate or change color.

Example of unsuitable products :

- Base : Alkaline detergent
  - For anodized parts not suitable for  $\text{pH} > 7$
- Acids : Hydrogen peroxide
  - For anodized parts not suitable for  $\text{pH} < 4$

In general, use cleaning products whose pH is neutral.

Please refer to the technical datasheet of your cleaning product to check whether it is suitable or not.

**NOTE :** Just because the surface treatment has changed color slightly does not mean the plate is eligible for a return under warranty.

## Ph-scale :

